

PUBLIC NOTICE # 2011-197

NOTICE OF CONDITIONAL USE

Pursuant to Section 2.4.2(B)(1)(e) of the Land Development Regulations of the City of Delray Beach, Florida, you are hereby notified that a conditional use request has been received for Delray Community Pharmacy, to allow within the Mixed Residential, Office and Commercial (MROC) zoning district, the construction of a drive-thru lane for the proposed Delray Community Pharmacy. The development proposal involves the demolition of the Goodman Automotive Care facility and construction of a 5,996 sq. ft. multiple tenant retail building that includes a 3,599 sq. ft. pharmacy with a drive-thru lane and two retail bays consisting of 1,253 sq. ft. and 1,144 sq. ft. respectively. The subject property is located at the southeast corner of Linton Boulevard and Congress Avenue.

The PLANNING AND ZONING BOARD will conduct a Public Hearing on **Monday, October 17, 2011 at 6:00 p.m.** (or at any continuation of such meeting which is set by the Planning and Zoning Board), in the Commission Chambers at City Hall, 100 NW 1st Avenue, Delray Beach, Florida, for the purpose of receiving public comments.

Additional information may be obtained by contacting Candi Jefferson at the Planning and Zoning Department Office, City Hall 100 NW 1st Avenue, Delray Beach, Florida 33444, Phone 561/243-7049, (e-mail at Jefferson@mydelraybeach.com) between the hours of 8:00 A.M. and 5:00 P.M. on weekdays (excluding holidays). All interested parties are invited to attend the public hearing and comment on the proposed conditional use or submit their comments in writing on or before the date of the hearing to the Planning and Zoning Department. PLEASE BE ADVISED THAT IF A PERSON DECIDES TO APPEAL ANY DECISION MADE BY THE PLANNING AND ZONING BOARD WITH RESPECT TO ANY MATTER CONSIDERED AT THIS MEETING OR HEARING, SUCH PERSON WILL NEED A RECORD OF THE PROCEEDINGS, AND FOR THIS PURPOSE SUCH PERSON MAY NEED TO ENSURE THAT A VERBATIM RECORD OF THE PROCEEDINGS IS MADE, WHICH RECORD INCLUDES THE TESTIMONY AND EVIDENCE UPON WHICH THE APPEAL IS BASED. THE CITY DOES NOT PROVIDE OR PREPARE SUCH RECORD PURSUANT TO F.S. 286.0105.

City of Delray Beach
Planning and Zoning Department
Date Posted: October 6, 2011

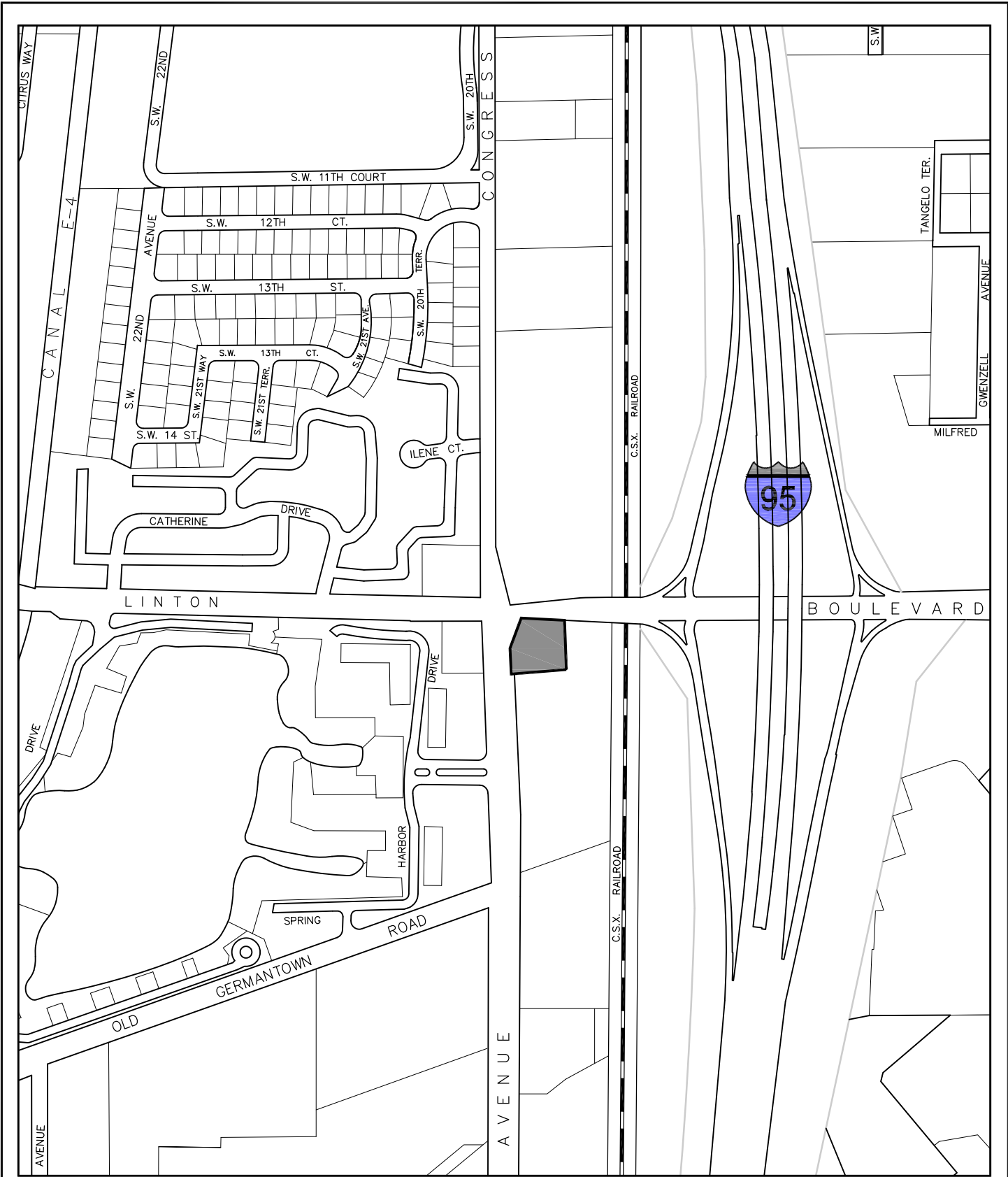

N

 PLANNING AND ZONING
 DEPARTMENT

SUBJECT PROPERTY

DELRAY COMMUNITY PHARMACY
 1601 SOUTH CONGRESS AVENUE
 LOCATION MAP